

LIGHT.POINT.COM

EDGE Collection

With its sculptural elegant silhouette, Edge Linear pendant brings both upward and downward light, creating a refined and atmospheric presence in any space. The elegant, high-quality finish enhances its architectural form, making it a natural centerpiece above dining tables or in meeting rooms. A newly retined compact ceiling base allows for more flexible installation, while freely mounted cables let you adjust the hanging position to suit your interior.



EDGE LINEAR

User Instructions

LIGHT•POINT
COPENHAGEN

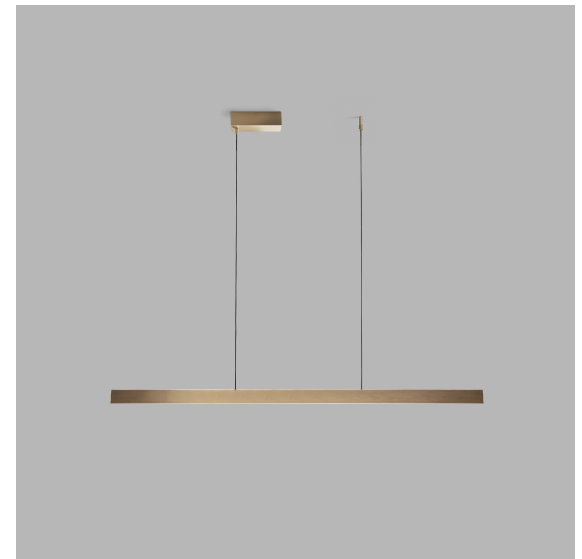

NOTE: The ceiling lamp base can be used as installation box.

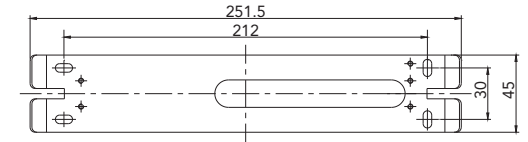
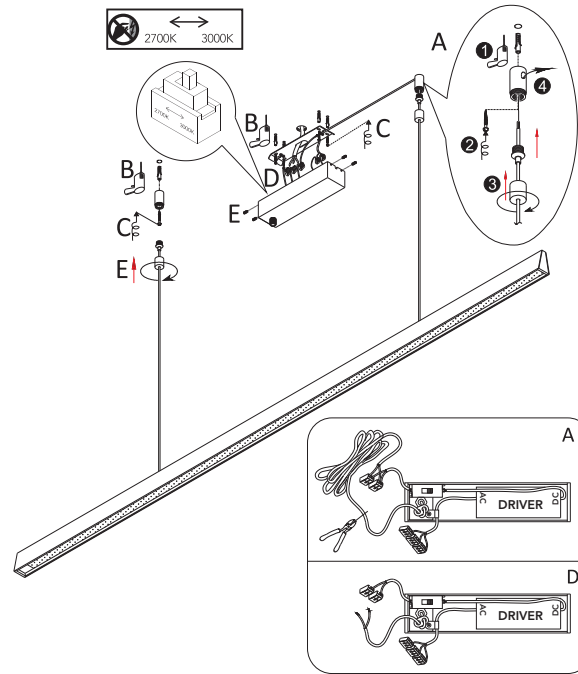
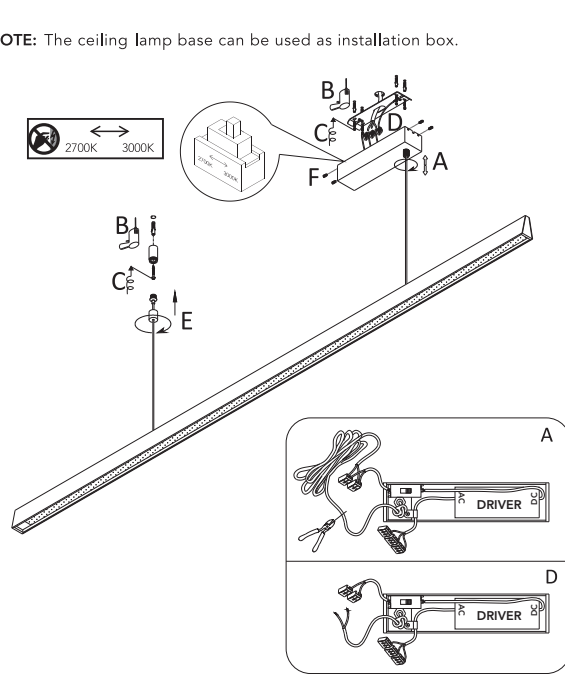

Installation instructions

- Before installing, make sure the power supply is switched off.
- Follow the steps as the figure for installation.
 - Loose the adjuster and adjust the cable to the length what you need.
Then tighten the adjuster. If there is some extra cable in the base, cut it and re-connect the cable as the previous way.
 - After drilling, pull out the wires.
 - Fix the bracket to the ceiling with screws.
 - Connect the wires to the terminal block.
 - Fix the fixture to the mounting bracket.
- After finishing every step, tighten the screws, have the fixture fixed, and then connect the power supply.

General use

- The product is designed for indoor use only.
- The lamp gets hot after prolonged use, therefore, do not cover the product.

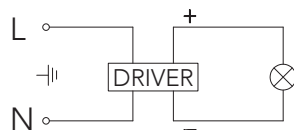

Cleaning instructions

- Before cleaning, ensure that the power supply is switched off.
- Wipe surface of lamp shade with a soft cloth.
- Do not use any abrasive cleaning tools such as steel wool, scouring sponges or stiff brushes.
- Never use strong cleaning agents such as white spirit, household glass cleaner or cellulose thinners.

Safety precautions

- The appliance should be installed, connected and tested by qualified electrician and in accordance with local regulations.
- Turn off the power supply before installation or maintenance of the lamp, and make sure that the cables are not squeezed or damaged by sharp edges during installation.
- The lamp should not be covered by insulation blankets or similar materials.
- Always turn off the main power supply before adjusting the colour temperature (2700K - 3000K) using the built-in switch or installing the luminaire.
- Using the colour temperature switch while powered may cause damage in the luminaire.

International warranty

Your product has gone through rigorous testing in order to live up to the highest quality standards. It therefore carries a 7-year warranty from the date of the original retail purchase receipt, covering defects in materials and workmanship when used normally in accordance with the published LIGHT-POINT guidelines.

These guidelines include but are not limited to information contained in technical specifications, safety instructions and quick start guides. LIGHT-POINT is not responsible for damage arising from failure to follow instructions relating to the use of the product.

LIGHT-POINT is a registered trademark of NORDIC LIVING GROUP.

For more information, please visit
LIGHT-POINT.COM

